



## ECM 51 Frame Commercial Refrigeration Motors

EM&S manufactures an ECM unit bearing construction motor that can serve as a drop-in replacement for the obsolete GE 55/44 frame ECM 1650 or 1850 rpm motor. This motor is available in a 9 watt and a 16 watt version. This promises substantial energy savings and potentially fast pay-back on the cost of conversion.

### Features:

- Ultra high efficiency • improved reliability
- Enhanced airflow performance
- Energy savings of 66 percent over a wide speed range
- Low operating temperature
- Lyall plug or EMF plug
- Accessories included with each motor; (1) speed nut, (1) resilient fan silencer, (3) 8-36 mounting screws, (1) rainshield
- Replaces GE ECM 55/44 frame motors

EM&S

### ECM installation's average annual energy savings versus shaded pole motors

05443	\$35
05444	\$55

@ 8¢ KWH and 1.75 multiplier on energy saving

### Specifications:

- Totally enclosed air over
- Unit bearing
- 1/4 - 20 threaded shaft
- 60 hertz

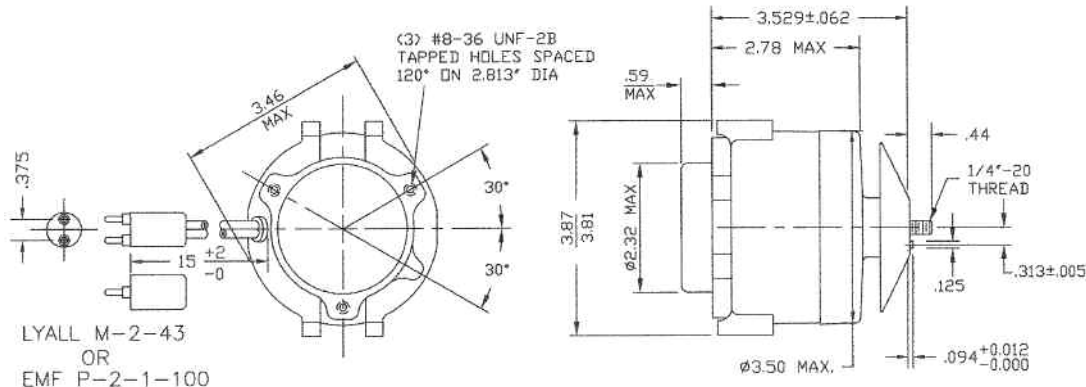

MARS NO.	WATTS	RPM	ROT OSE	VOLTS	AMPS	LEAD LENGTH
05443	9	1650	CW	115	.32	12"
05444	16	1850	CW	115	.4	12"